

woolyard

Availability and Space Plans

52–56 Bermondsey Street, London Bridge SE1

Availability and Space Plans

Schedule of Areas

Building	Floor	Unit	Desks	Maximum occupancy	Sq ft	Sq m
The Warehouse	3rd	10	32	44	LET	LET
The Warehouse	1st	5	14	14	919	85.4
Total					919 Sq ft	85.4 Sq m

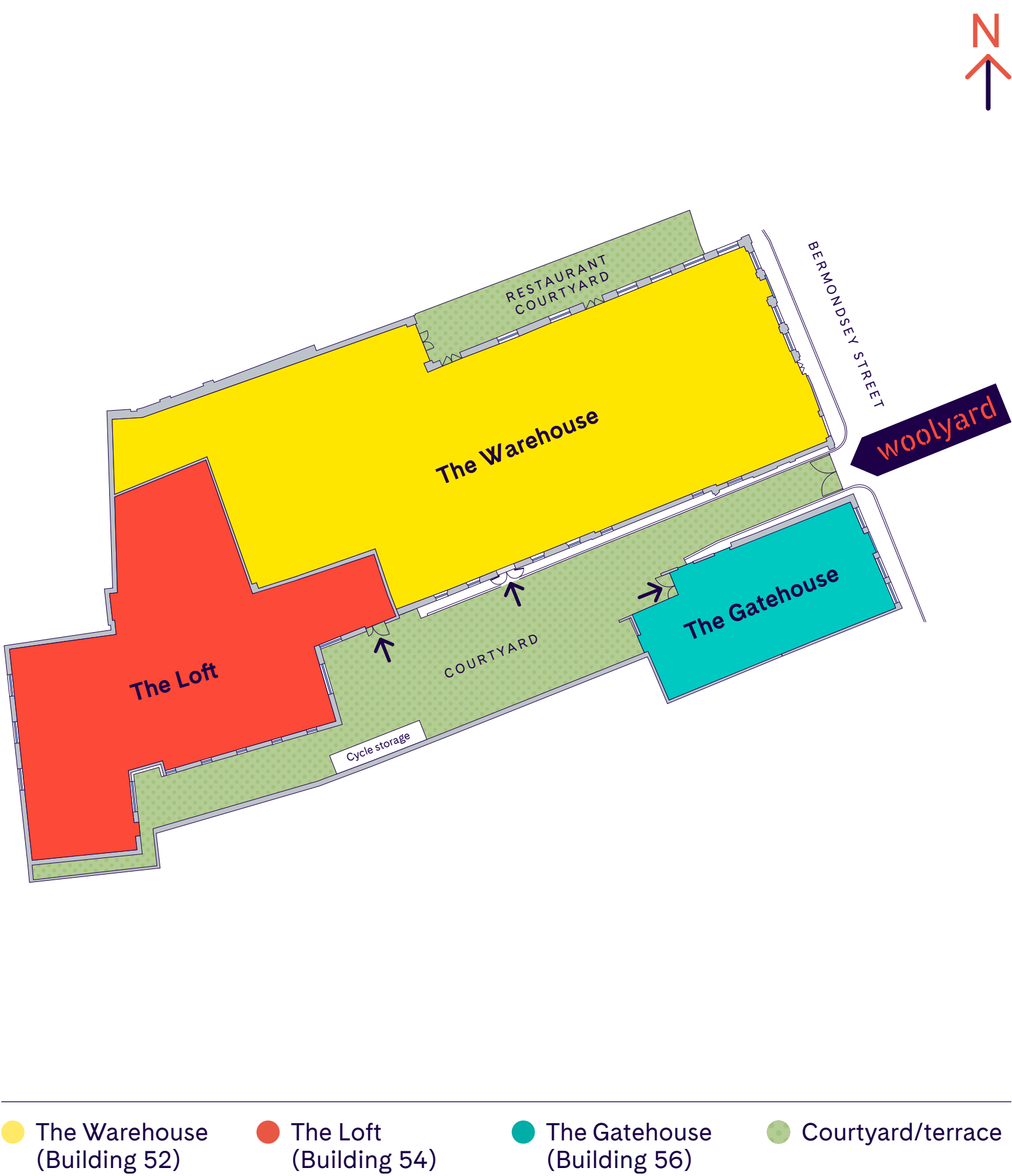
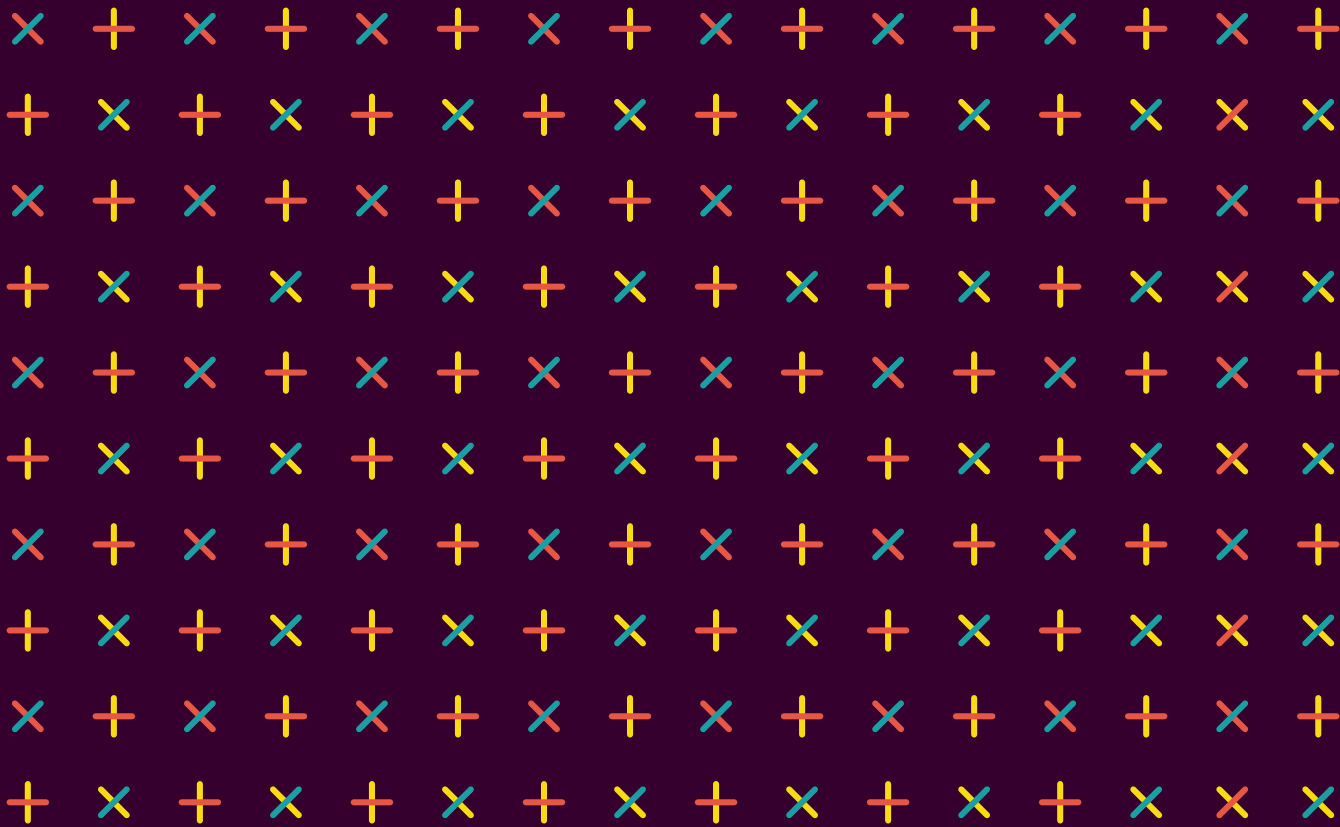

Unit 5, The Warehouse

1st Floor

Total Floor Space

919 sq ft (85.4 sq m)

- The Warehouse (Building 52)
- The Loft (Building 54)
- The Gatehouse (Building 56)
- Courtyard/terrace
- Roof

Desks	14
Maximum occupancy	14
Meeting room (4 person)	1
Breakout pod	1
Tea point/breakfast bar	1
Printing zone	1

Plans are not to scale, for indicative purposes only.

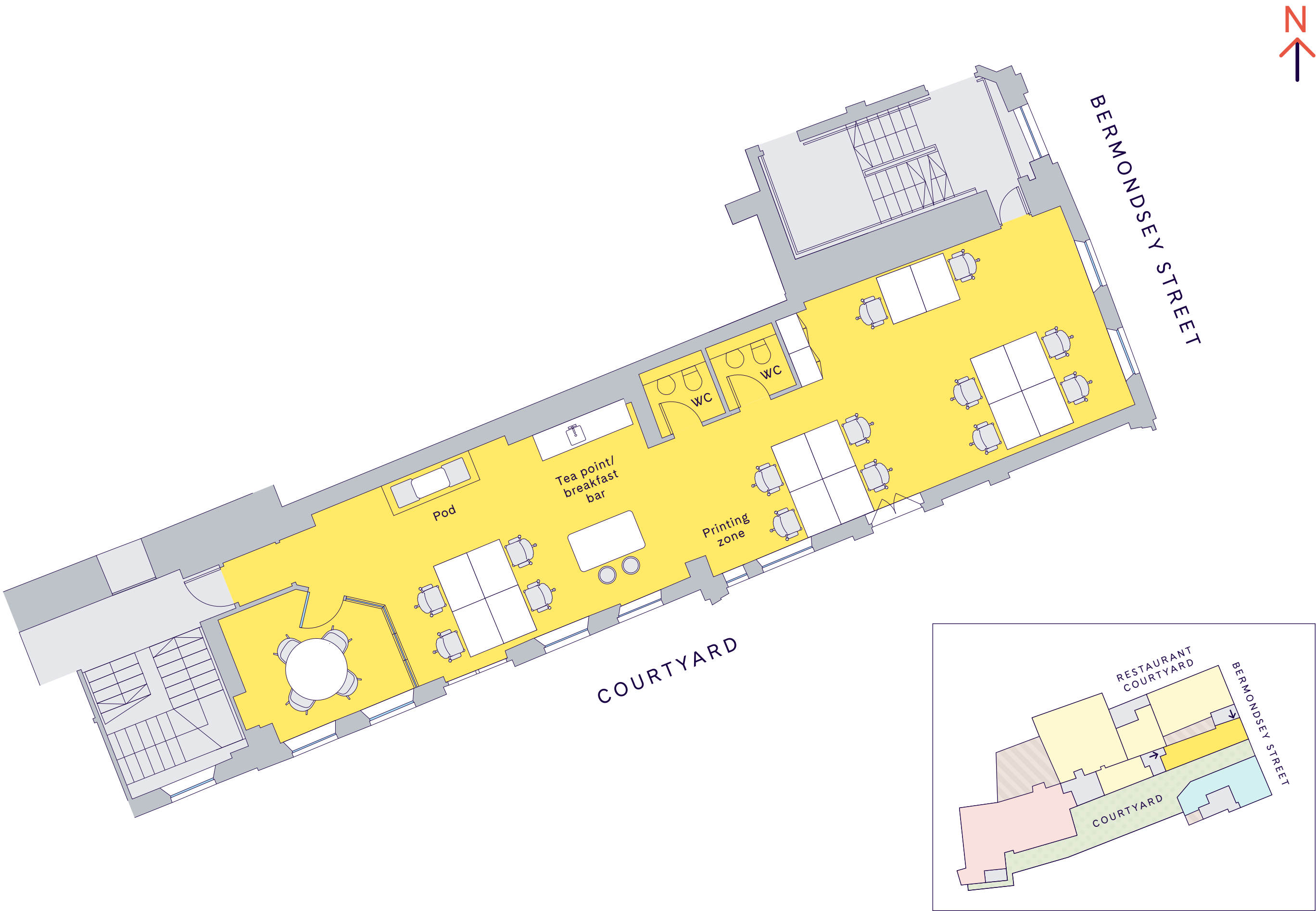



Your own desk space – Unit 5, The Warehouse



Your own desk space – Unit 5, The Warehouse



Your own kitchen – Unit 5, The Warehouse





Your own meeting rooms – Unit 5, The Warehouse

Get in touch

CBRE

Adam Cosgrove
07500 872 851
adam.cosgrove@cbre.com

Anna Tweed
07713 590 049
anna.tweed@cbre.com

Luke Thurlow
07522 305 878
luke.thurLOWE@cbre.com

Rob Russell-Smith
020 7647 3049
rob.russell-smith@gpe.co.uk

Owned and managed by

GPE.

woolyard.co.uk

Agent disclaimer CBRE, and its joint agents, Situu, give notice that these particulars are set out as a general outline only for the guidance of intending Purchasers or Lessees and do not constitute any part of an offer or contract. Details are given without any responsibilities and any intending Purchasers, Lessees or Third Party should not rely on them as statements or representations of fact, but must satisfy themselves by inspection or otherwise as to the correctness of each of them. No person employed or engaged by CBRE, or its joint agents, Situu, has any authority to make any representation or warranty whatsoever in relation to this property. All computer-generated images (CGIs) and photography images are indicative only. (December 2021)

/situu

Tom Leahy
07955 147 734
tom@situu.co.uk

Dan Brown
07710 249 297
dan@situu.co.uk

Kate Prior
07946 132 523
sales@situu.co.uk

woolyard